

ELECON  
GEARBOX  
4"NU  
60: 1 RATIO

COUPLING bearing

bearing

CROMPTON  
FLP MOTOR  
5 HP

DETACHABLE FRAME

M12 BOLT FIXING

BEARING HOUSING  
WITH  
OIL SEAL

plywood for safety  
damper shutter  
with acrylic sheet

JACKETwith Stiffeners

AGITATOR RPM = 4.5 Approx.  
with 4 rubber wiper arms  
SHEET THICKNESS

PAN = 4mm  
JACKET = 3mm  
All Flanges Class 150  
Fine Finish

FOR: SOLAR INDUSTRIES INDIA LTD.		
DRAWN	KFE	02/01/26
CHK'D	RANJAN	03/01/26
APPV'D	SHAKEEL AHMED	04/01/26

**BCM TOOL TECH**  
**HYDERABAD**

TITLE: **PETN DRYER**  
**CAPACITY 300KG**

DWG NO. **BCM PD06**

\*UNLESS OTHERWISE SPECIFIED: DIMENSIONS ARE IN MILLIMETERS

MATERIAL **SS316**

SHEET 1 OF 3

A4

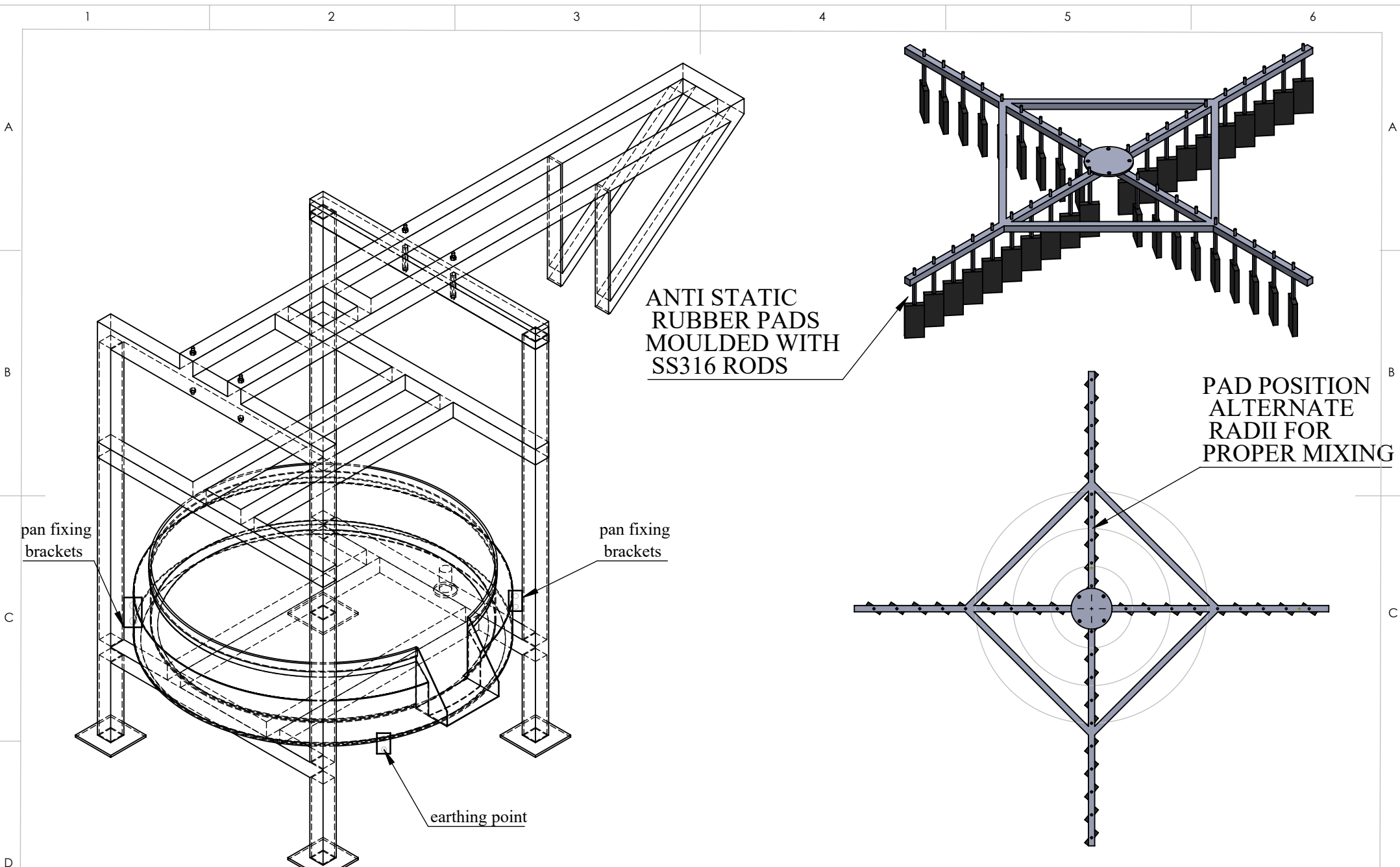

FOR: SOLAR INDUSTRIES INDIA LTD.		
DRAWN	KFE	02/01/26
CHK'D	RANJAN	03/01/26
APPV'D	SHAKEEL AHMED	04/01/26

**BCM TOOL TECH**  
**HYDERABAD**

TITLE:	<b>PETN DRYER</b> CAPACITY 300KG
DWG NO.	BCM PD06

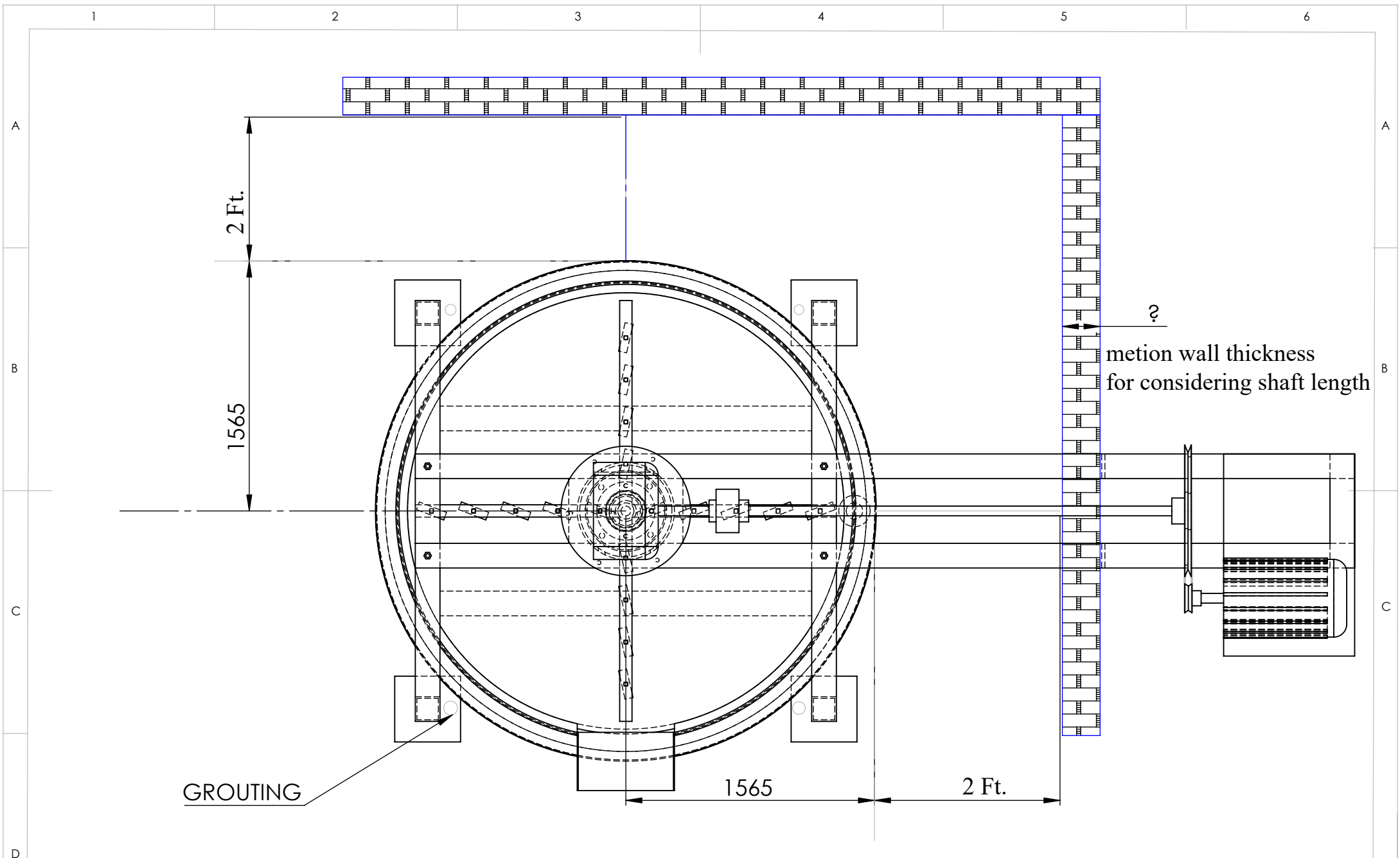

FOR: SOLAR INDUSTRIES INDIA LTD.		
DRAWN	KFE	02/01/26
CHK'D	RANJAN	03/01/26
APPV'D	SHAKEEL AHMED	04/01/26

**BCM TOOL TECH**  
**HYDERABAD**

TITLE:	<b>PETN DRYER</b> <b>CAPACITY 300KG</b>
DWG NO.	<b>BCM PD06</b>